



YUKTAN TECHNOLOGIES



Healthcare League & Nursing Education

February 24-26
2020

Venue

SANA Malhoa Hotel
Av. José Malhoa 8
1099-089 Lisbon, Portugal

Venue Floor

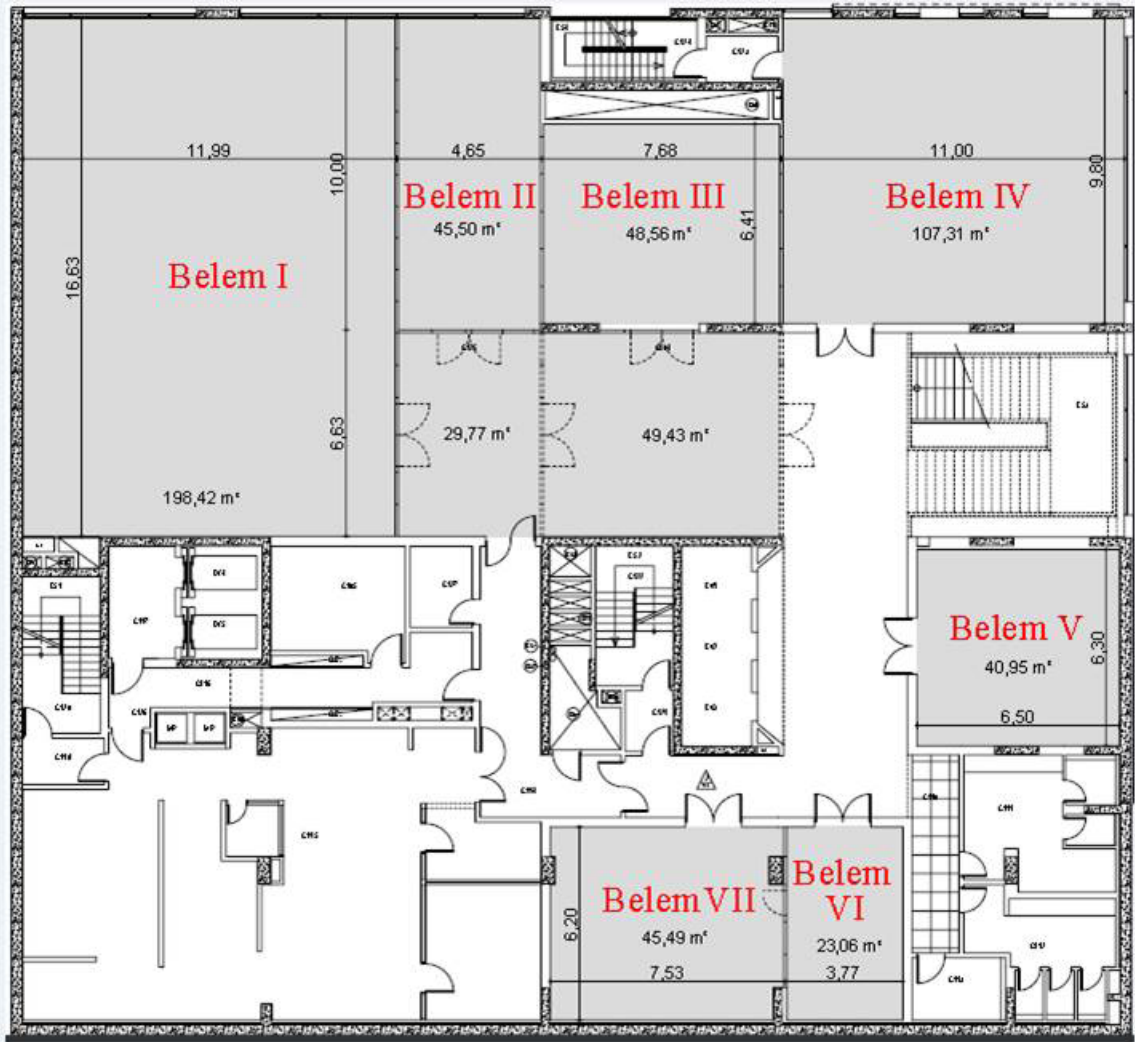

SSID – MALHOA EVENTOS

Pass = malhoa2019



We are excited to use Whova as our event platform.
Attendees please download Whova event app.



The event invitation code is: **nurzu**

Hall : Belem 1

08:30-09:00 Registrations and Opening Ceremony

Plenary Talk

09:00-10:30 Menopause: Flammable-Handle with Care
Diane Todd Pace, University of Tennessee Health Science Center, USA

10:30-10:50 Coffee Break @ Foyer

Special Talk

10:50-11:40 The Co-Morbidities and Social Complications of Epilepsy
Ian Brown, University of Oxford, UK

Keynote Presentations

11:40-12:10 The Importance of Having a Healthy Workplace to Address Nursing Staff Burnout
Denyse Henry, Canadian Association of Ambulatory Care (CAAC), Canada

12:10-12:40 An Innovative Approach to Preparing Future Nurses
Peggy C. Walters, Duke Regional Hospital & Watts School of Nursing, USA

12:40-13:10 An Evaluation of the Effect of a Patient Assessment E-learn Campaign on Clinical Assessment Practices by Surgical Nurses
David Glanville, Epworth HealthCare, Australia

13:10-14:00 Lunch Break

14:00-14:30 Increasing the Quality of Life with Hyperthermia in Oncological Patient
Sophie Badzgaradze, Medical Clinic "SAROV", Georgia

14:30-15:00 Professional Empowerment and Evidence-based Nursing
Abílio Cardoso Teixeira, ICBAS – UP, Portugal

15:00-15:30 A Novel Anti-cytokine Technology: Shooting Many Cytokines with a Single Stone
Yutaka Tagaya, Institute of Human Virology University of Maryland School of Medicine, USA

15:30-16:10 Panel Discussion

Sexual Health: A State of Physical, Emotional, Mental, and Social Well-being
Diane Todd Pace, University of Tennessee Health Science Center, USA
Fusun Terzioglu, Atılım University, Turkey

16:10-16:30 Coffee Break @ Foyer

16:30-17:00 Bion's Theory of Containment in Healthcare
João Vilas Boas, Barreiro Montijo Hospital Center, Portugal

- 17:00-17:30** **A New Innovative Strategy in Nursing Education: Hybrid Simulation and High-Fidelity Simulation**
Fusun Terzioglu, Atılım University, Turkey
- 17:30-18:00** **Neuroinflammation as Part of a Possible Neuro-regeneration in a Patient with ASIA-A Scale Using Combinatorial Biologics: Bioquantine® and Allogeneic Mesenchymal Stem Cells**
Joel Isaias Osorio Garcia, RegenerAge® - Bioquark, Inc, USA
- 18:00-18:30** **The New Deal in Occupational Health: OMS-OIT Policies**
Rosa M. Orriols, WHO Advisor, Spain
- 18:30-19:30** **Cocktail & Networking**

DAY 2

Tuesday | February 25, 2020

Hall : Belem 1

Plenary Talk

- 09:00 -10:30** **Genitourinary Syndrome of Menopause (GMS) – The Need to Have the “Talk”**
Diane Todd Pace, University of Tennessee Health Science Center, USA

10:30-10:50 **Coffee Break**

@ Foyer

10:50-11:50 Panel Discussion: Social Network Analysis Applied to Health Care

Panel Chair: *Pilar Marqués-Sánchez, University of Leon, Spain*

Nursing and Social Network Analysis: A Relational and Structural Approach

Pilar Marqués-Sánchez, University of Leon, Spain

Social Network Analysis and the Health Research Question

María López, University of Valladolid, Spain

Social Network Analysis: Graph Visualizations and Mixed Methods Approach in Healthcare Settings

Roser Fernández Peña, University of Cantabria, Spain

Understanding the Enduring Impact of Complex Environments and Individual Factors on Everyday Obesity Related Practices: A Social Network Approach

Nestor Serrano-Fuentes, University of Southampton, UK

Workshop

- 11:50-12:50** **An Evidence-Based Exercise Program: Reducing Falls in the Elderly**
Angela Cruz, West Texas Veteran Affairs (VA) Healthcare System, USA

12:50-13:30 **Lunch Break**

Keynote Presentations

- 13:30-14:00** **Combinatorial Biologics for Skin Rejuvenation Activating the Tissue Regeneration**
Lejla Stojanovic, MD, Regenerage® Europe, Serbia
- 14:00-14:30** **Advanced Therapy Medicinal Products: Value Judgement and Ethical Evaluation in Health Technology Assessment**
Elisabete Gonçalves, CTI Clinical Trial & Consulting, Portugal
- 14:30-15:00** **Nursing Students Orientation Toward Patient-Centredness and Empathy: A Longitudinal Study**
Ana Grilo, Lisbon School of Health Technology, Portugal
- 15:00-15:30** **Effect of Home Care Service on the Sexual Satisfaction of Patients with Gynaecologic Cancer**
Fusun Terzioğlu, Atilim University, Turkey
- 15:30-16:00** **Specific Learning Disorder, Cognitive Strategies and Learning Styles in the School Environment**
Monica Pellerone, University of Enna, Italy

16:00-16:30 Coffee Break and Poster Presentations @ Foyer

- HLNC-01** **Evolution to University-Based RN First Assistant Education for APRNs**
Diane Todd Pace, The University of Tennessee Health Science Center, USA
- HLNC-02** **Distributed Leadership, Occupational Self-Efficacy and Stress in Italian Public Health-Care Contexts**
Massimiliano Barattucci, e-Campus University, Italy
- HLNC-03** **Exploring Healthcare Needs and Psychosocial Impact of Living with Advanced COPD in Palliative care**
Barbara E. Gonçalves, University of the West of Scotland, UK
- HLNC-04** **A Universal Mental Health Program for Young People in Italy to Prevent Internet Addiction Behavior and Improve Mental Health**
Antonella Gigantesco, Italian National Institute of Health, Italy
- HLNC-05** **Smart Phone-Based Image Analysis Coupled to Paper-Based Colorimetric Devices**
Sanghyo Kim, Gachon University, South Korea

Oral Presentations

Chair: *Ian Brown, University of Oxford, UK*

- 16:30-16:50** **Bullying Among Young Male Athletes: Analysis of the Narratives of Athletes and Coaches**
Miguel Nery, European University of Lisbon, Portugal
- 16:50-17:10** **Poor Cancer Screening Perceptions Associated with Low Socioeconomic Status Among Malaysian**
Shamsul Azhar Shah, National University of Malaysia, Malaysia
- 17:10-17:30** **Health Policies of Turkey and Neighborhood Countries for Syrian Asylum Seekers**
Mustafa Necmi İlhan, Gazi University, Turkey

Hall : Belem 6

Keynote Talk

09:00-09:30 **HIV-Associated Neurological Disorders: The Role of Neuronal Cytoskeleton**
Valeria Avdoshina, Georgetown University Medical Center, USA

Oral Presentations

Chair: *Peggy C. Walters, Duke Regional Hospital & Watts School of Nursing, USA*

09:30-09:50 **The Nursing Rounds System: Effect of Patient's Call Light Use, Bed Sores, Fall and Satisfaction Level**
Bassem Salah Saleh, Security Forces Hospital Program, Saudi Arabia

09:50-10:10 **Suicidal Risks in the Military and Veteran Population**
Angela Cruz, West Texas Veteran Affairs (VA) Healthcare System, USA

10:10-10:30 **An Evidence-Based Fall Prevention Program Among Psychiatric Patients**
Shirlene Sulatan, West Texas Veteran Administration Health Care System, USA

10:30-10:50 **Coffee Break** @ Foyer

10:50-12:00 **Panel Discussion: 2020 And Beyond In Pharmaceutical Medicine**

Panel Chair: *Helena Sofia Antão, MD, Medical Affairs Manager, Angelini, Portugal*

Motivating Investigators Throughout Medicines Lifecycle
Helena Sofia Antão, MD, Medical Affairs Manager, Angelini, Portugal

Medical Departments 2.0
Paula Martins de Jesus, MD, Medical Director, MerckSharp & Dohme, Portugal

Patient Safety Issues in the Everchanging World of Medical Devices
João Paulo Guimarães, MD Clínica Gerações, Portugal

Oral Presentations

Chair: *Angela Cruz, West Texas Veteran Affairs (VA) Healthcare System, USA*

12:00-12:20 **Flu Pathogenesis Proteolytic Theory and it's Role in the Improvement of Flu's Treatment**
Valentina Divocha, Lugansk State Medical University, Ukraine

12:20-12:40 **Experience with Infection in Congenital Cardiac Surgeon with Extracorporeal Membrane Oxygenation Support**
Mukaddes Nüseybe SÖYLEMEZO, Anatolia Medical Center Hospital, Turkey

12:40-13:00 **Hospital Microbial Surface Colonization Revealed During Monitoring of *Klebsiella spp.* and *Pseudomonas aeruginosa***
Paula V. Morais, University of Coimbra, Portugal

13:00-13:40 Lunch Break

- 13:40-14:00** **Phylogenetic Analyses of the Rprd&Vp1 Overlap Region C and Rprd Region A of the Detected *Norovirus* Genomes in Baghdad Province**
Khaled A.Habeb, University of Baghdad, College of Science for Women, Iraq
- 14:00-14:20** **Nurse's Role in Cardiovascular Surgery Intensive Care Unit**
Melike ÇAKIR, İstanbul Cerrahpaşa University, Turkey
- 14:20-14:40** **Dispatcher-Assisted and Bystander-Initiated Resuscitation Efforts are Low During Night-time in Out-of hospital Cardiac Arrest Cases Witnessed by Non-Family**
Hideo Inaba, Kanazawa University Graduate School of Medicine, Japan
- 14:40-15:00** **Compassionate Fatigue, Burnout, Traumatic Stress Among Nurses**
Usama Saleh, King Abdullah Medical City, Saudi Arabia
- 15:00-15:20** **Investigation of Stress Coping Style and Affecting Factors of Midwifery Department Students: Example of Faculty of Health Sciences**
Nurten Ozen, Demiroglu Bilim University, Turkey
- 15:20-15:40** **Health, Healing and Faith in the Philippine Culture: An Analysis of Cases**
Maria Irma Bustamante, Philippine College of Health Sciences, Philippines

15:40- Coffee Break, Closing Ceremony & Departures



We wish to see you
at
Healthcare League & Nursing Education 2021
Lisbon, Portugal

Organising Partner

GED Biomedical Innovations AB

Per Albin Hanssons vag 41
Malmo- 20512, Sweden
Phone: +46 40 666 53 35

Administrative Office

Yuktan Technologies Pvt Ltd

1 Raffles Place, #44-01A
One Raffles Place
Singapore 048616

committee@nursingconnect.net; shareef.m@nursingconnect.org
<https://nursingconference.yuktan.com/>
<https://healthcareconference.yuktan.com/>